2024 SAPA

HEALTHCARE INVESTMENT Forum & Roadshow

"SCIENCE MEETS CAPITAL,
INVESTMENT ALLIES BUSINESS DEVELOPMENT"



Sino-American
Pharmaceutical
Professionals
Association

Saturday, June 22, 2024
Hyatt Regency New Brunswick



SAPA Healthcare Investment Forum & Roadshow

Vision

To become the premium platform for investors and entrepreneurs in healthcare.

Mission

To connect with trusted partners and offer effective solutions and support to emerging enterprises in healthcare. To promote entrepreneurship, healthcare investment and business cooperation.

Table of Content

Event Program at-a-Glance	04
Investment Forum Program	05
Floor Map for the Event	07
Roadshow and Showcase Participants	08
Session Overview	09
Speakers & Panelists Introduction	11
Judges	19
Organizing Committee	20
Participating Investors	24
Sponsors	25
Introduction of SAPA	27
Upcoming SAPA Events	28

Why You Should Participate?

Investment is crucial for companies in life sciences to survive, prosper, and bring your innovations to the next stage, especially in this challenging era. Get more funding and stay on the safe side!

Come and join the 2024 SAPA Healthcare Investment Forum and Roadshow:



Understand the latest trends in investment and drug development;



Interact with the leading investors in life sciences;



Opportunities to out-license your technology and product;



Receive professional review and suggestions for your roadshow materials and get endorsed by the pharmaceutical veterans at SAPA;



Access to a full spectrum of investors from angel fund to late stage investors, as well as BD representatives from biotech and pharma;



1:1 deep-dive meetings providing opportunities to showcase your project;



Connect with your peers, share your experience and learning in securing the investments;



Establish connections and open your door to talents, partners and many other resources;

Event Program at-a-Glance

Saturday, June 22, 2024
Hyatt Regency New Brunswick

9:00 AM – 12:00 PM

Plenary Session and Panel Discussions *Regency D, E, F (First Floor)*

9:00 AM – 9:10 AM

Opening Remarks , SAPA Introduction

9:10 AM – 9:30 AM

Plenary Presentation: Capital Markets and IPO Updates

Eric J. Dimise, Sector Lead, Healthcare & Life Sciences Capital Markets, New York Stock Exchange

9:30 AM – 9:50 AM

Plenary Presentation: Scientific Breakthrough in Prevention, Treatment and Cure of Chronic Hepatitis B

Zhi Hong, Executive Director, Chairman of the Board and CEO of Brii Biosciences

9:50 AM – 10:05 AM

Group picture, sponsor highlights and coffee break

10:05 AM – 11:00 AM

Panel discussion I: Biotech Startups and Venture Capital: A Symbiotic Relationship

11:00 AM – 11:55 AM

Panel discussion II: Accelerating Innovation through Business Developments

12:00 PM – 1:30 PM

Sponsor highlights and Lunch Break *Regency D, E, F (First Floor)*

1:30 PM – 5:00 PM

Parallel Sessions

I. Roadshow and Company Showcase

Garden State Ball Room (First Floor)

II. Executives Ins and Outs

Salon A,B (Second Floor)

- 1:30 PM -1:35 PM Opening
- 1:35 PM -3:15 PM Part I
- 3:15 PM -3:30 PM Coffee break
- 3:30 PM -4:55 PM Part II
- 4:55 PM -5:00 PM Closing

III. 1:1 Partnering

Conference Room I, J, K (Second Floor)

5:00 PM – 6:30 PM

Reception and Networking *Brunswick Ballroom (Lower Level)*

Ticket required to attend

Investment Forum Program

Saturday, June 22, 2024
Hyatt Regency New Brunswick

8:30 AM – 9:00 AM	Registration Checking-in	Regency D Alcove (First Floor)
9:00 AM – 12:00 PM	Plenary Session and Panel Discussions	Regency D, E, F (First Floor)
9:00 AM – 9:10 AM	Opening Remarks , SAPA Introduction Wei Ding and David Cragin	
9:10 AM – 9:30 AM	Plenary Presentation: Capital Markets and IPO Updates Eric J. Dimise, Sector Lead, Healthcare & Life Sciences Capital Markets, New York Stock Exchange	
9:30 AM – 9:50 AM	Plenary Presentation: Scientific Breakthrough in Prevention, Treatment and Cure of Chronic Hepatitis B Zhi Hong, Executive Director, Chairman of the Board and CEO of Brii Biosciences	
9:50 AM – 10:05 AM	<i>Group picture, sponsor highlights and coffee break</i>	
10:05 AM – 11:00 AM	Panel discussion I: Biotech Startups and Venture Capital: A Symbiotic Relationship Moderator: Xiaodong Chen, Senior Director of CMC, Roivant Sciences Panelists: <ul style="list-style-type: none"> • Wenseng (Wendy) Pan, Partner, Goodwin Procter LLP • Yaniv Sneor, Founder, Mid Atlantic Bio Angels • Sally Wang Liang, Partner, Highlight Capital • Lin Yu, Managing Director, CBC Group • Bing Yuan, CEO, OnCusp Therapeutics 	
11:00 AM – 11:55 AM	Panel discussion II: Accelerating Innovation through Business Developments Moderator: Jack Wu, SD, S&E, Global Oncology, Takeda and President, SAPA Panelists: <ul style="list-style-type: none"> • Jeffrey Lin, Executive Director, BD, Jiangsu Hengrui Pharmaceuticals Co., Ltd. • Patrick Moriarty, Executive Director, Business Development, Merck • Pan Pan, Senior Director, Head of Business Development, OncoC4 Inc. • Alfred Rumondor, Director, Bristol Myers Squibb • Wei Shao, Associate Director BD & Strategy, Alexion AstraZeneca Rare Disease 	

12:00 PM – 1:30 PM		Sponsor highlights and lunch break	Regency D, E, F (First Floor)
1:30 PM - 5:00 PM		Parallel Sessions	
Parallel Session I	Roadshow and Company Showcase Session Leads: Jianming Kang, David Zhang and Han Zhang		Garden State Ball Room (First Floor)
Parallel Session II	Executives Ins and Outs Session Leads: Bob Ai and Pan Pan <ul style="list-style-type: none"> 1:30 PM -1:40 PM Opening: Pan Pan 1:35 PM -2:00 PM Bob Ai, Managing Partner, Goby Global "The Critical Roles of IR* and PR* for Your Company" 2:00 PM -2:25 PM Zhenggui (Kevin) Li, Special Counsel, McCarter & English LLP "Legal Considerations in Setting Up and Operating Companies in the US" 2:25 PM -2:50 PM Tina Sun, Partner, Taurus Financial "Navigating Finance, Tax, and Employee Benefits for Startups" 2:50 PM -3:15 PM Annie Shen, Sr Partner, PageExecutive "Construct a Functional and Capable Executive Team" 3:15 PM -3:30 PM Coffee break 3:30 PM -3:55 PM Lihua Zheng, Co-Founder & CEO, Z-Star Therapeutics Inc. "Fundraising and Exit Strategies in a Challenging Environment" 3:55 PM -4:55 PM Panel Discussion: All speakers 4:55 PM -5:00 PM Closing: Pan Pan 		Salon A, B (Second Floor)
Parallel Session III	1:1 Partnering Session Leads: Yuhan Wei		Conference Room I, J, K (Second Floor)
5:00 PM -6:30 PM		Reception and Networking	
Ticket required to attend			Brunswick Ballroom (Lower Level)

*IR: investor relation; PR: public relation

Hyatt Regency New Brunswick

First Floor

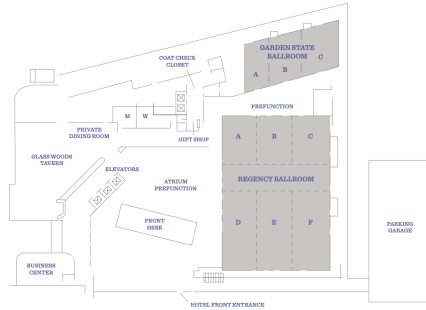

Second Floor

Second Floor

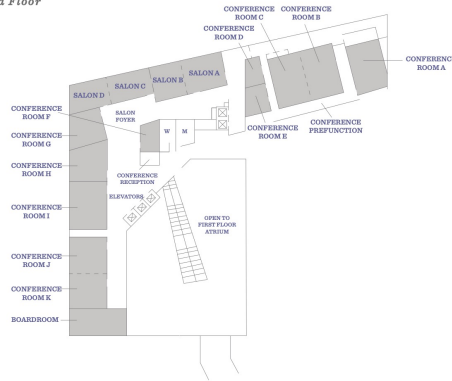

Lower Level

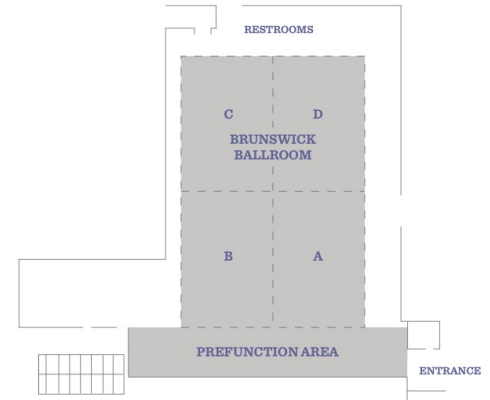

Roadshow and Showcase Participants

No.	Organization Name
1	AllianThera Biopharma*
2	Anteng Easyway International Limited
3	Auson Pharma
4	BaseCure Therapeutics*
5	Celeon Therapeutics*
6	Clickmab Biotech (Suzhou) Co., Ltd.*
7	Defand Therapeutics*
8	EmpEars
9	HB Therapeutics, Inc.*

No.	Organization Name
10	Hopstem Biotechnology Inc.
11	iVIEW Therapeutics*
12	Kanglin Biotechnology (Hangzhou) Co.,Ltd.
13	OptiCardio*
14	RenuMemo Therapeutics
15	Sirrona Therapeutics*
16	Xsome Biotech Inc.*
17	Z Advanced Computing, Inc. (ZAC)

*Companies presenting onsite

Plenary Presentation

Capital Markets and IPO Updates



Eric J. Dimise,
PhD

Sector Lead, Healthcare & Life Sciences
Capital Markets,
New York Stock Exchange

Plenary Presentation

Scientific Breakthrough in Prevention, Treatment and Cure of Chronic Hepatitis B



**Zhi Hong,
PhD**

Executive Director,
Chairman of the Board and
CEO of Bii Biosciences

Panel Discussion I

Biotech Startups and Venture Capital: A Symbiotic Relationship



Moderator
Xiaodong Chen,
PhD

Senior Director of CMC, Roivant Sciences



Wenseng (Wendy) Pan,
PhD

Partner, Goodwin Procter LLP



Yaniv Sneor

Founder, Mid Atlantic Bio Angels



Sally Wang Liang,
JD, MPH

Partner, Highlight Capital



Lin Yu,
PhD

Managing Director, CBC Group



Bing Yuan,
PhD, MBA

CEO, OnCusp Therapeutics

Panel Discussion II

Accelerating Innovation through Business Developments



Moderator

**Jack Wu,
PhD, MBA**

SD, S&E, Global Oncology, Takeda
President, SAPA



**Jeffrey Lin,
PhD**

Executive Director, BD,
Jiangsu Hengrui Pharmaceuticals Co., Ltd.



**Patrick Moriarty,
PhD**

Executive Director,
Business Development, Merck



**Pan Pan,
PhD, MBA**

Senior Director,
Head of Business Development,
OncoC4 Inc.



**Alfred Rumondor,
PhD**

Director, Bristol Myers Squibb



**Wei Shao,
PhD**

Associate Director BD & Strategy,
Alexion AstraZeneca Rare Disease

Parallel Session II

Executives Ins and Outs



Moderator

**Bob Ai,
PhD, MBA**

Managing Partner, Goby Global



Moderator

**Pan Pan,
PhD, MBA**

Senior Director, Head of Business Development,
OncoC4 Inc.

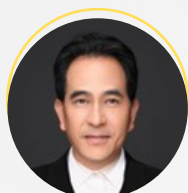

**Bob Ai,
PhD, MBA**

Managing Partner,
Goby Global



**Zhenggui (Kevin) Li,
JD**

Special Counsel,
McCarter & English LLP



**Annie Shen,
MBA, MS**

Sr Partner, PageExecutive



**Tina Sun,
MS, CFA**

Partner, Taurus Financial



**Lihua Zheng,
PhD, JD**

Co-Founder & CEO,
Z-Star Therapeutics Inc.

Speakers & Panelists Introduction



**Eric J. Dimise,
PhD**

Sector Lead, Healthcare & Life Sciences, Capital Markets, New York Stock Exchange

Eric J. Dimise, PhD, is Sector Lead, Healthcare & Life Sciences Capital Markets NYSE Group, a part of Intercontinental Exchange, Inc. (NYSE: ICE). Eric is responsible for attracting new listings from companies within the healthcare and life sciences industry. He advises companies, private equity and venture capital firms, investment bankers, and other key stakeholders on the IPO landscape, NYSE initiatives, and listing venue selection. Prior to joining NYSE, Eric served as Vice President and Team Lead of Healthcare Content and Events at Gerson Lehrman Group (GLG), overseeing a team that curated market-driven events for investor clients with coverage in the pharmaceutical, biotechnology, and medical device and diagnostics sectors. Before GLG, Eric worked as a Cardiovascular and Metabolic Disease Analyst at GlobalData. He completed his doctoral training in Chemistry at Boston College and a postdoctoral research fellowship at Harvard Medical School. While in academia, Eric's research focused on natural product and synthetic organic chemistry as well as microbial communication in the environment and the human microbiome.



**Zhi Hong,
PhD**

Executive Director, Chairman of the Board and CEO of Bii Biosciences

Dr. Hong co-founded Bii Bio in 2018 and has served as Chief Executive Officer since the company's inception. Prior to starting Bii Bio, Dr. Hong was Senior Vice President and Head of GlaxoSmithKline's (GSK) Infectious Diseases Therapy Area Unit. He was widely credited as the key architect of GSK's comeback and success in anti-HIV, anti-HBV and antibiotics medicine discovery and development. Under his leadership, ViiV Healthcare's (a joint venture between GSK, Pfizer, and Shionogi) HIV business was revitalized with the approval of Tivicay, Triumeq, Cabenuva and Apretude. His leadership also led to the discovery and development of gepotidacin (gram negative antibiotic) and bepirovirsen (anti-HBV) to late stage development.



**Bob Ai,
PhD, MBA**

Managing Partner, Goby Global

Bob Ai, Ph.D. MBA, is the founder and Managing Partner of Goby Global, which provides investor relations, public relations, capital market, cross-border licensing, fundraising, and other strategic advisory services. Goby also publishes a newsletter covering healthcare news in Asia-Pacific region. Bob was previously a Managing Director at Solebury Trout, a subsidiary of PNC Bank. Bob has played various roles in the IPO process and/or investor relations post-IPO for companies such as I-Mab, Zai Lab, Junshi Biosciences, Impact Therapeutics, Kintor, YS Biopharma, CASI Pharma, Taiwan Liposome Company (TLC), etc.

Prior to Solebury Trout, he held roles as a hedge fund analyst, private equity fund principal, senior sell-side analyst, and public company chief financial officer (EDOC Acquisition Corp).

Bob received his PhD and MBA from Penn State University and completed postdoctoral training at University of Pennsylvania. He has published several articles in peer-reviewed scientific journals and was awarded the prestigious Ray Wu (CUSBEA) scholarship for outstanding Chinese student to study abroad. Bob holds Series 7, 63, 79, 86, and 87 securities licenses, which are currently inactive.



**Jeffrey Lin,
PhD**

Executive Director, BD, Jiangsu Hengrui Pharmaceuticals Co., Ltd.

Jeffrey Lin joins Hengrui as an Executive Director, BD from Starbloom Capital where he has been instrumental in building the firm's venture investments in biotechnology as a Venture Investor in multiple therapeutic areas including oncology. Jeffrey has had in depth experience in oncology from his time as a Senior Director at GSK where he has led pipeline strategy along with multiple external evaluations and due diligence such as the Tesaro and Sierra Oncology acquisitions. Earlier in his career, Jeffrey has worked at Leerink Partners as an Equity Analyst, a consultant at Pennside Partners and both preclinical and clinical oncology work at the Cleveland Clinic as a post-doc.

Jeffrey earned his PhD in Biochemistry from Tulane University but did most of his doctoral research in Chicago due to Hurricane Katrina. He also holds a Masters in Engineering and a Bachelor of Science both from the University of Florida.

Outside of work, Jeffrey lives in the Wayne, PA area just outside of Philadelphia with his wife and two children and enjoys travel, learning new languages and cultures, cooking, camping and hiking and teaching Chinese yo-yo at the local Chinese school.



**Zhenggui Li,
JD**

Special Counsel, McCarter & English, LLP

Zhenggui "Kevin" Li is a member of McCarter & English's Corporate practice group as well as a member of the firm's inter-disciplinary International practice group. Kevin advises large and medium-sized companies in mergers and acquisitions, whether on the buyer's side or on the seller's side. Kevin counsels companies and their executives on company restructuring, compliance and reporting, and various types of general corporate matters. Kevin also handles financing matters, including venture capital transactions, representing either investment funds or start-up companies, and secured and unsecured loan transactions, representing both lenders and borrowers. In his capacity as a member of the firm's International practice group, Kevin is constantly involved in the firm's international business initiatives and serves on the firm's legal team in representing various types of cross-border transactions.



**Patrick Moriarty,
PhD**

Executive Director, Business Development, Merck

Patrick Moriarty, PhD, MBA is an Executive Director in the Business Development and Licensing organization of Merck. In this role, he seeks to identify, evaluate, and execute on partnering and acquisition opportunities that fit within Merck's strategic research and development goals in oncology.

Prior to joining Merck, Patrick was a senior analyst at Early Harvest Fund and an analyst at HealthCor Management, focusing on oncology, immunology, and other therapeutic areas. Earlier in his career, he was as an Equity Analyst at Fortis Bank and an Associate Director in Equities Research at UBS. In both of these positions, Patrick covered the small and mid-cap biotech sector. Prior to this, he was a Senior Clinical Research Scientist at Novartis and was involved in drug development in the CNS space.

Patrick received his undergraduate education at the University of Pennsylvania. He received a PhD in Psychology from Hofstra University and completed an MBA at the NYU Stern School of Business.



Pan Pan,
PhD, MBA

Senior Director, Head of Business Development, OncoC4 Inc.

Dr. Pan Pan has a rich and diverse experience spanning over a decade in Business Development. During this period, he actively contributed to the remarkable growth of strategic partnerships within the biopharmaceutical industry, while witnessing development setbacks due to misalignment among alliance partners. Dr. Pan has dedicated his efforts to accelerating drug development in oncology and immunology through strategic planning and partnering. His primary objective is to forge collaborations that maximize program value using innovative models.

His track record in establishing successful partnerships includes Kelun's groundbreaking ADC license to Merck, resulting in \$1.4 billion in total payments. He orchestrated the Akeso-Summit partnership for Iponescimab (PD-1/VEGF bsAb), securing a landmark upfront of \$500M and total payments of \$5B. Dr. Pan's prior scientific experience as a protein engineer at Arkema Inc complements his business acumen. Dr. Pan firmly believes that a solid foundation for a successful partnership lies in sound scientific and business assessments. His ability to deftly navigate both scientific and business domains is owed to his educational background. He holds a PhD in Chemistry from Stony Brook University, an MBA from the University of Massachusetts Amherst, and an MS & BS from the School of Pharmacy at Peking University.



Alfred Rumondor,
PhD

Director, Bristol Myers Squibb

Alfred Rumondor is an experienced professional with a diverse background in food and pharmaceutical industries. He earned his Bachelor's degree in Chemical Engineering from Purdue University in 1998, followed by a Master's degree from Cornell University in 1999. In the early stages of his career, Alfred immersed himself in the food industry, specializing in formulation work for products such as yogurt, nutritional shakes, and supplement tablets. His passion for pharmaceuticals led him to pursue a PhD in Pharmacoeutics from Purdue University, which he completed in 2009. Since obtaining his doctorate, Alfred has held various roles in pharmaceutical companies, focusing on formulation and drug product design. His contributions to the field are evidenced by his portfolio of 23 publications and patents, reflecting his commitment to innovation and excellence in pharmaceutical sciences. Alfred's expertise also extends to CMC leadership and business development-related activities including support for due diligence, contracting, and alliance management.



Wenseng (Wendy) Pan,
PhD

Partner, Goodwin Procter LLP

Dr. Wenseng "Wendy" Pan, Leader of Goodwin's Asia Life Sciences practices, specializes in complex mergers and acquisitions, licensing and strategic partnership as well as private and public financing transactions, especially in the life sciences and technology industries and in cross-border settings. With extensive experience in both private and public mergers and acquisitions (M&As), Dr. Pan is a trailblazer in cross-border M&A transactions involving Chinese companies. Her representations include the first acquisition of a US Nasdaq company by a PRC company, the first sale of a therapeutic asset invented in China to a global big pharma and first royalty financing transaction on royalty stream from China. A renowned cross-border business lawyer, she has deep experience in structuring and negotiating complex in-licensing, out-licensing and strategic transactions, involving a variety of technologies, modalities and therapeutic areas.

Dr. Pan has been recognized by IFLR1000 as a leading lawyer for M&A and has been in the 2016 edition of Who's Who Legal: Life Sciences (Transactional) and ranked for excellence by Chambers for Life Sciences in the Greater China Region. She is a recipient of the 2023 recipient of Biocentury/BayHelix "Woman Leader of the Year" Award, and was nominated for the 2023 LMG "Licensing Lawyer of the Year" Award.

Dr. Pan is the chair of the BayHelix Group, a not-for-profit life sciences professional association.



Wei Shao,
PhD

Associate Director BD& strategy, Alexion AstraZeneca Rare Disease

Dr. Shao is an experienced BD and investment professional. He currently serves as Associate Director of Business Development and Strategy at Alexion AstraZeneca Rare Disease, responsible for sourcing rare disease innovations across the globe. Prior to Alexion, he spent years as a healthcare investor focusing on public equity investment and crossover financing in biotech companies, most recently as Vice President at Octagon Capital Advisors. He received PhD training in neuroscience and genetics at Weill Cornell Medicine and Memorial Sloan Kettering Cancer Center.



**Annie Shen,
MBA, MS**

Sr Partner, PageExecutive

PageGroup is an UK listed, global recruitment consulting company with 141 offices across 37 countries. They specialize in helping businesses find top talent in a range of industries, including life sciences, Technology, Financial Service, Manufacture, Consumer and more.

Page Executive is the executive search division of PageGroup and focuses on helping businesses find C-suite and other high-level executives. They have a strong presence in the life sciences industry, and our clients include pharmaceutical, biotech, and medical device companies. Annie is leading the Life Science and Technology practice of North America region, including USA and Canada.

Annie is a trusted advisor to business owners, investors and CEOs of local and multinational companies operating in North America looking for executive hiring and talent insight. She focuses on helping clients solve complex recruitment challenges that reside at the intersection of business operations and workforce development. She works together with a highly experienced team of consultants that specialize in Life Sciences and Technology Industries, place C-suite and VP level executives across various functional team globally.

Before joining executive recruitment industry, Annie was a research scientist. She graduated from China State (Shanghai) Institute of Pharmaceutical industry with master's degree majoring in Microbiology Pharmaceutical. After obtaining her second master's degree in business administration from the University of Illinois. Then she joined the management and recruitment consulting industry. To date, she has accumulated over 12 years of experience in recruiting top-tier professionals globally.



**Tina Sun,
MS, CFA**

Partner, Taurus Financial

Tina Sun is a co-founder and partner at Taurus Financial and Taurus Solution. Taurus Financial, a boutique advisory firm, serves executives, entrepreneurs, and businesses throughout the United States. Taurus Solution is a comprehensive one-stop-shop offering extensive finance, tax, and HR solutions to startups.

Before establishing Taurus, Tina spent a decade at Credit Suisse, where she was instrumental in originating and distributing complex derivative products to private banks, broker-dealers, and registered investment advisors.

Tina graduated from the University of Michigan and holds professional designations as a CFA, CIAA, and EA. She was recognized as one of Forbes' Top Best-in-State Financial Security Professionals in 2022 and 2023.



Yaniv Sneor

Founder, Mid Atlantic Bio Angels

Yaniv Sneor is one of the founders of MABA – Mid Atlantic Bio Angels (bioangels.net) a life science angel investor group, where he also administers MABA's internal investment pools, and MABA's co-investment Sidecar Fund (<https://bioangels.net/sidecar-fund-ii/>), for non MABA member investors.

Mr. Sneor is also Chief Executive Officer of Native State Therapeutics, an early stage biotechnology company in the neurodegeneration field, and President of Blue Cactus Consulting (bluecactusconsulting.com) a business strategy consulting group.

Yaniv Sneor is originally a physicist, who made the transition into the business world about 30 years ago, at which point he took the helm of his first company. Mr. Sneor has senior merger, acquisition, capitalization, turnaround leadership experience with companies ranging from start-up to growth. He has held positions of CEO, COO, President, and General Manager at a number of companies, including a bio-informatics company, a surgical laser company, a manufacturing and distribution company, a software and network integration company, and several others.

Mr. Sneor mentored numerous life science and technology start-ups through BiomedX (the Columbia-Coulter Translational Research Partnership), the Bench-to-Bedside Initiative jointly sponsored by Weill-Cornell Medical Center, and the E-Lab for Life Science Entrepreneurs sponsored in part by the New York City Economic Development Corporation.



**Sally Wang Liang,
JD, MA**

Partner, Highlight Capital

Sally Wang Liang JD MPH is a Partner at Highlight Capital, a top-tier Asian healthcare and life sciences venture capital firm with a global footprint and portfolio. She has been serving as Venture Partner at Viva Bioinnovator (VBI), the life sciences corporate venture of Viva Biotech with 91 portfolio companies, the majority of which are US-based. She has been the Board of Director or Observer of 8 U.S. biotech companies and have managed 11 of VBI's companies. She is actively involved in the biotech ecosystem, as Expert-in-Residence and President's Innovation Challenge Judge at the Harvard iLab, and mentor with MassBio, Nucleate, and LabCentral.

Previously, Sally was SVP of Business Development, Head of the Global Business Unit at a peptide therapeutics company and Entrepreneur-in-Residence at a company involved in in-licensing promising university technology into NewCo. She has substantial operating, business development, and fundraising experience as a serial entrepreneur: as the CEO and Co-founder of an international telemedicine company and as Chief Strategy Officer and EVP of IP and Regulatory of a leading digital therapeutics company. As a lawyer, she practiced pharmaceutical patent litigation and IP licensing at the premier intellectual property firm and clerked for a federal judge. She worked on healthcare policy at the national level at the Food and Drug Administration Office of Policy and the US Senate Health Education Labor Pension Committee Health Office. She began her career as a management consultant at Clarion Healthcare. Sally received an A.B. in Biology from Harvard College, a J.D. from Harvard Law School, and a M.P.H. from Harvard T.H. Chan School of Public Health.



**Lin Yu,
PhD**

Managing Director, CBC Group

Lin is a Managing Director for the Private Credit & Royalty Strategy at CBC. Prior to joining CBC, he was a Managing Director at Oppenheimer Healthcare Investment Banking, where he served a dual role as the lead of the firm's Healthcare Royalty Monetization business and an advisor for companies on equity capital markets strategies. Before joining Oppenheimer, he was a Managing Director at BTIG Healthcare Investment Banking. Previously, Lin was a Principal on the Healthcare Private Equity Team at KKR dedicated to its royalty and private credit strategy. He also served as a Director of Investment Research and Analysis at DRI Capital, a healthcare royalty-focused private equity firm. Earlier in Lin's career, he was an Equity Research Analyst covering medical devices and technologies at Cowen & Co. He earned a PhD and an MS from Columbia University in chemical engineering, where he focused his research on next-generation DNA sequencing technologies. Lin received a BS in chemical engineering from The Cooper Union for Advancement of Science and Art.



**Lihua Zheng,
PhD JD**

Co-Founder & CEO, Z-Star Therapeutics Inc.

Lihua is a serial entrepreneur and biotech executive. He is currently co-founder and CEO of Z-Star Therapeutics Inc., a New York City-based biotech developing the next generation immune oncology therapies. Previously, he co-founded AnHeart Therapeutics in 2018 as its Board Director and Chief Business/Strategy Officer responsible for business development, financing, legal and US operation. He led the successful in-licensing of three clinical-stage oncology assets from Daiichi Sankyo. He also led the out-licensing of commercial rights separately to Nippon Kayaku, Inovvent Biologics and NewG labs with upfront and milestone payments totaling more than \$300 million plus double-digit royalties. He further led the efforts in raising more than \$100 million in private venture financing before AnHeart was merged into Nuvation Bio (NYSE: NUVB) in Q1 2024. Lihua was previously a legal and business advisor for more than 10 years first at an international law firm and then at a boutique law firm in New York City that he co-founded. He received his J.D. from Fordham University School of Law and a Ph.D. in Molecular and Human Genetics from Baylor College of Medicine. He obtained his Masters and Bachelor of Science degree from Fudan University.



**Bing Yuan,
PhD, MBA**

Co-Founder and CEO, OnCusp Therapeutics

Dr. Bing Yuan is a seasoned business executive and entrepreneur with 20+ years of biopharma experience, made significant contributions to 14 approved global oncology brands during his career, including blockbusters such as Keytruda and Glivec.

In early 2021, he co-founded OnCusp Therapeutics, a New York based clinical stage biotech company dedicated to transforming cutting-edge preclinical innovation into clinically validated treatments for cancer patients worldwide. He successfully built the team, developed a portfolio of innovative assets, and raised a total of \$139M in Seed and Series A financing rounds supported by world leading biotech investors.

Before co-founding OnCusp, he was Chief Strategy and Business Officer at CStone Pharmaceuticals, achieved 10+ deals with leading global companies such as Pfizer, Bayer, Blueprint, Agios and EQRx. As a senior executive from the beginning, he helped to build CStone from startup to successful IPO in just three years and had managed over 10 different business functions.

Prior to joining CStone in 2016, he was Global Lead of Oncology BD&L at Merck (MSD) in New Jersey, led or contributed to 30+ licensing, M&A and Keytruda clinical collaboration deals. Before Merck, he held various global commercial positions with increasing responsibilities at Novartis Oncology, most recently as Executive Director and Head, Brand Life Cycle Strategy. He also played key roles in new product strategy, business development and global launch of a lung cancer drug. He used to be Global Oncology Marketing Lead at Eisai, managing the oncology portfolio.

Dr. Yuan holds a Ph.D. in Molecular Biology from Columbia University, an MBA from Cornell University and a BS in Biochemistry from Nanjing University.

Judges



**Yangzi He,
PhD, MBA**

Associate Director, Search & Evaluation,
Bristol Myers Squibb



**Yingzhong Li,
PhD**

President,
SunVax mRNA Therapeutics Inc.



**Guanghui Hu,
PhD**

Founding Partner,
Westfield BioVentures



**Sally Wang Liang,
JD, MA**

Partner, Highlight Capital



**Jason Zhang,
PhD**

Head-Corporate Venture Fund,
JSR Life Sciences



**Mark Tang,
PhD, MBA, MPH**

Managing Director, Good Health Capital,
Chairman, World Biotech Capital LLC



**Ximei Sun,
PhD**

VP, LongRiver Investment



**Ma Rui,
PhD**

Partner, FreeS Fund

Event Co-Chairs



Wei Ding, PhD

Senior Director, Alexion AstraZeneca



Jun (Stephen) Xue, MS

General Manager, Chipscreen Biosciences (US) Ltd

Session Leads



**Bob Ai,
PhD, MBA**

Managing Partner, Goby Global



**Jianming Kang,
PhD**

Senior Scientist,
Regeneron Pharmaceuticals, Inc.



**Pan Pan,
PhD, MBA**

Senior Director, Head of Business Development,
OncoC4 Inc.



**Yuhao Wei,
MS**

Scientist II, Ingenus Pharmaceuticals



**Han Zhang,
PhD**

Graduate Student Researcher,
University of Pittsburgh



**David Zhang,
MS**

Engagement Manager, AWS



Organizing Committee

Event Co-Chairs

Wei Ding, PhD
Jun (Stephen) Xue, MS

Committee Members

Anbo Zhou, PhD
Bolin Li, MS
Brian Jiang, MS
Chen Kang, PhD
Chenchao Gao, PhD
Chuxuan Wang, MS
Claire Wang, MPH
Danni Zhang, MS
David Cragin, PhD, DABT
David Zhang, MS
Eileen Han, PhD
Feiyi Sun, MS
Han Zhang, PhD
Iris Gao, PhD
Jack Li, MS
Jack Wu, PhD, MBA
Jessie Li
Jiafan Chen, MS

Jianming Kang, PhD
Jiaying Liu, PhD
Jingwen Song, PhD
Junchi Lu, PhD
Juntao He, PhD
Lingzhi Zhao, PhD
Linxuan Yan, JD
Lisheng Zhou, PhD
Nan Sun, PhD
Pan Pan, PhD, MBA
Qi Wang, PhD
Ruicheng Yao, MPH
Shengjie Xu, PhD
Shuai Li, PhD
Shuangyi Xu, MS
Ting-Him Chan, LL.M, Esq
Xi Cheng, MPH, MS
Xiaodong Chen, PhD

Yang Ge, PhD
Yannan Liu, PhD
Yannuo Li, PhD
Yongmei Li, PhD
Yu Tian, PhD
Yuhan Wei, MS
Yutong Wu, MS
Zheman Zhao, MS
Zhiying Li, PhD
Zhou Yu, MS
Zixian Deng, PhD

Speakers & Panelists



Participating Investors



| Sponsors





uhcasian.com

There for what matters

30 years of dedicated service to the Asian community as a dependable partner

Asian Initiatives
30th Anniversary

亞裔市場 • 아시안 부서 • Bức Khởi Đầu Châu Á

© 2024 United Healthcare Services, Inc. All rights reserved. Y0066_20240306AI_C

General Inquiry:
1-800-801-1900 (TTY 711)
Monday-Friday, 9 a.m.-5 p.m.

United
Healthcare®

Introduction of SAPA

The Sino-American Pharmaceutical Professionals Association (SAPA) was established in 1993 and is headquartered in the center of the pharmaceutical corridor in New Jersey, USA. Since its inception, SAPA rapidly became one of the most active Chinese American professional associations in the US with eight chapters and more than 6,000 members.

SAPA's members are primarily from large and mid-sized pharmaceutical and biotech companies in the US, with areas of expertise covering almost every aspect of pharmaceutical research and development as well as production.

The organization's large membership base and their superb scientific and technical abilities has allowed SAPA to be a key source for knowledge exchange on the latest developments in the pharmaceutical, biotechnology, and generic drug industries.

As a non-profit organization registered in the US, SAPA receives generous sponsorship and support from numerous multinational companies in the US and overseas. SAPA will continue to provide a broad platform for scientific and technical discussion, talent exchange, and training for the colleagues in the pharmaceutical industry from the US and China.

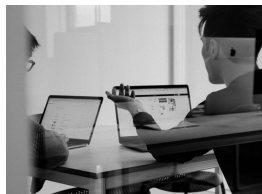

1993
establish

8
chapters

6000+
members

SAPA Sites and Chapters:

- SAPA-HQ (Headquarter): New Jersey, USA
- SAPA-NE (New England Chapter): Boston and New England region, USA
- SAPA-GP (Greater Philadelphia Chapter): Philadelphia and other Pennsylvania areas, USA
- SAPA-MW (Mid-West Chapter): Illinois and Indiana, USA
- SAPA-CT (Connecticut Chapter): Connecticut, USA
- SAPA-DC (DC Chapter): District of Columbia and Maryland, USA
- SAPA-China: Zhengzhou and Beijing, China

Professional Expertise of SAPA Members



Drug discovery, research
and development



Preclinical and clinical
research and development



Application and registration of
new drug and biologics to the
US FDA



Production and manufacture of
pharmaceuticals and biological
products



Commercial and marketing of
pharmaceutical and biological
products



Generic product development
and technology

Upcoming SAPA Events

Event	Date
SAPA-HQ, NE, DC Summer Picnic	August 2024
SAPA-HQ 31st Annual Conference	September 26-28th, 2024
SAPA-NE Scientific Symposium	October 2024 (TBD)
SAPA-China Annual Conference	October 18-19th, 2024
SAPA-DC Annual Conference	October 19th, 2024
SAPA-CT Annual Conference	November 9th, 2024



Sino-American
Pharmaceutical
Professionals
Association

2024 SAPA Summer Picnic

Sunday, August 20, 2024
Oak Grove Pavilion, Duke Island Park
191 Old York Road
Bridgewater, NJ 08807



<https://sapaweb.org>





Sino-American
Pharmaceutical
Professionals
Association



2024 SAPA Annual Conference

**Redefining Medicine: Navigating
Resilience, Transforming Lives**



Friday and Saturday, September 27 - 28, 2024
Hyatt Regency New Brunswick
2 Albany St., New Brunswick, NJ 08901

<https://sapaweb.org>





Sino-American
Pharmaceutical
Professionals
Association



2024 SAPA Career Talk 8@8

Science
Education
Collaboration
Career

SAPA Career Talk 8@8 is a virtual webinar series hosted on the 8th day of every month at 8 pm. We will discuss career hot topics and address concerns relevant to SAPA members and friends. These sessions are complimentary to all.



<https://sapaweb.org>

8 pm on the 8th day of every month.

SAPA Career Talk 8@8 is a virtual webinar series hosted on the 8th day of every month at 8 pm. We will discuss career hot topics and address concerns related to SAPA members and friends. These sessions are complimentary to all.

Scan the QR code on the right to register for the event, and join us from 8:00 – 9:30 pm, on the 8th day of each month. Please note that at the Zoom registration page you can register for all of the 2024 8@8 monthly program, so please make sure to select the right month from the pull-down menu. After registering, you will receive a confirmation email containing information about how to join the session.

